

MARCO

BELL®
s.r.l.

**SPACCALEGNA - LOGSPLITTER
HOLZSPALTER - FENDEUSE DE BOIS**

BOLIK 100 "US"

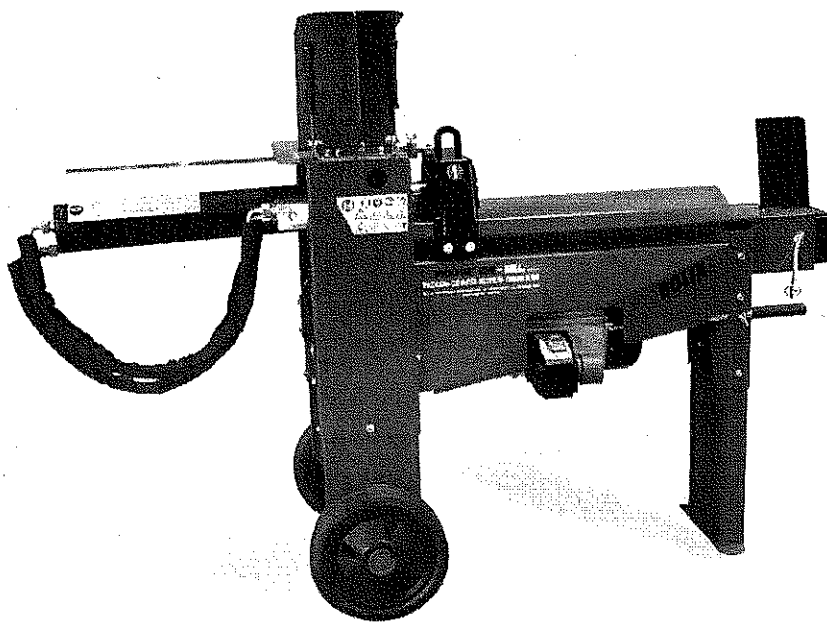

D22000620 ver.0 - UPD 030506 - © 2006 BELL

**MANUALE DI USO E MANUTENZIONE
MANUAL FOR USE AND MAINTENANCE
WARTUNGS-UND BETRIEBSANLEITUNG
LIVRET D'EMPLOI ET D'ENTRETIEN**



PICKPINE 

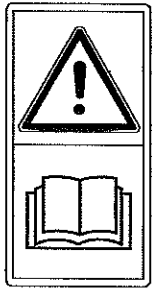

CE

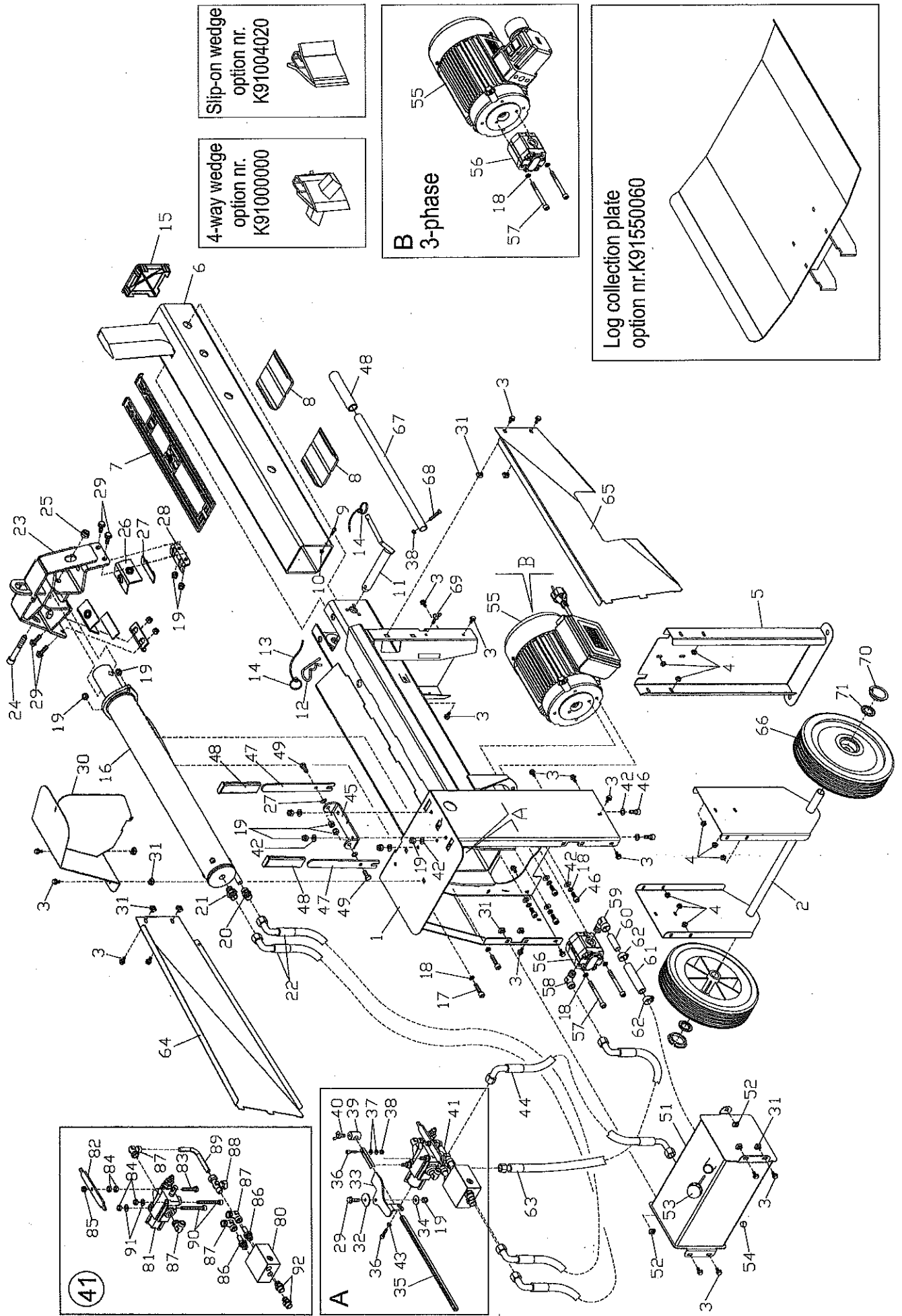

Slip-on wedge
option nr.
K91004020

4-way wedge
option nr.
K91000000

B
3-phase

Log collection plate
option nr. K91550060

Key	Code	Key	Code
1	D05030680	46	E26075102
2	D05130430	47	B71150150
3	E26050520	48	E28560200
4	E26530442	49	E26035096
5	B77120290	50	E26830055
6	D05560020	51	D05170300
7	B50010150	52	E26640010
8	B50010090	53	E28400015
9	E26075063	54	E26620248
10	E26561311	55	D01100120 1-phase
11	D05411155	55	D01100020 3-phase
12	E27072020	56	E53010047 1-phase
13	E27102010	56	E53010017 3-phase
14	E27120030	57	E26075114 1-phase
15	B82110010	57	E26075113 3-phase
16	D80060170 J7206110	58	E51201136
17	E26075105	59	E51141033
18	E26840016	60	B55630795
19	E26561344	61	D55080710
20	E51091028	62	E27700120
21	E51011122	63	D55060410
22	D55060420	64	B62100240
23	D05240210	65	B62100250
24	E26075161	66	E31650030
25	E26560446	67	B71200020
26	B50010080	68	E26035068
27	B50010030	69	E26451085
28	B77120300	70	B82110090
29	E26051550	71	E26790010
30	D05111480	80	D02102740
31	E26600050	81	E55760300
32	B47000130	82	B71100300
33	B71150140	83	E26035100
34	E26770160	84	E26515038
35	B41080115	85	E26561344
36	E26075087	86	E51120000
37	E26760013	87	E51041136
38	E26560312	88	E51061146
39	B41000620	89	B55570220
40	E26451200	90	E26075112
41	D02102750	91	E26760014
42	E26760014	92	E51201122
43	E26515036		
44	D55060500		
45	B77120440		

Cylinder

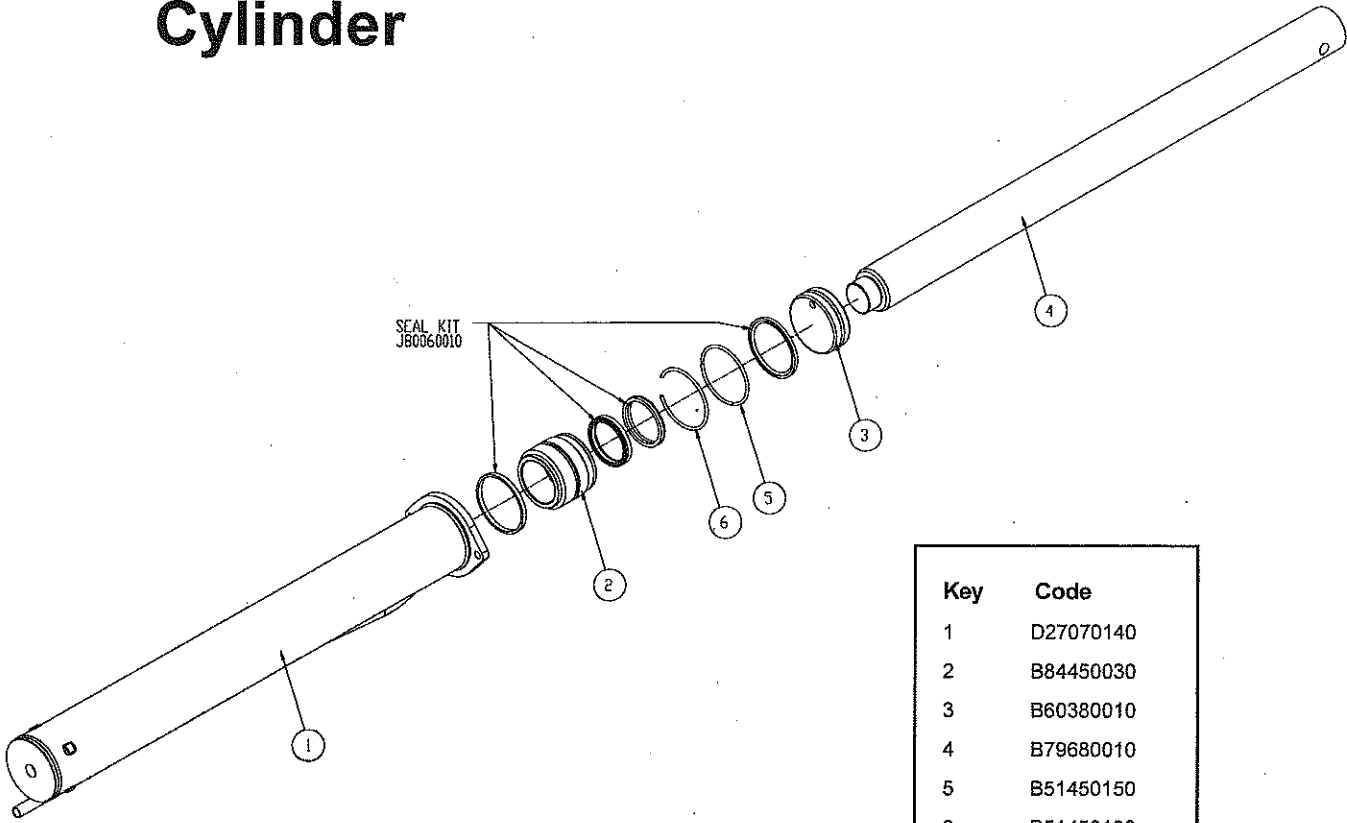

Key	Code
1	D27070140
2	B84450030
3	B60380010
4	B79680010
5	B51450150
6	B51450130